

KC RO Plus **5-stage Reverse Osmosis System**

User Manual



Table Of Contents

Introduction to the KC RO Plus	2
System Specifications	2
Dimensions and Weight	2
Performance Specifications.....	3
Feed Water Requirements.....	3
Description of System and Replacement Intervals.....	3
Installation Overview	4
Pre-Installation Checklist	4
Installation - Push Handle Air-gap Faucet	5
Installation - Feed Connection.....	6
Installation - Drain Connection.....	7
Installation - System Activation and Flushing	8
Final Installation Checklist.....	9
Maintenance	10
Maintenance - Main Cartridge Replacement.....	10
Maintenance - Post Filter Replacement	11
Maintenance - Tank Replacement.....	12
Installation and Maintenance Record	13
Limited Warranty	14



Tested and Certified by WQA against NSF/ANSI Standards 58 for the reduction of claims specified on the Performance Data Sheet.

Introduction to the KC RO Plus

Congratulations on your purchase of the KC RO Plus reverse osmosis system. The KC RO Plus features a four-stage prefilter, membrane and postfilter housed in a single system cartridge. The fifth stage, an in-line carbon postfilter, is placed between tank and faucet.

When properly maintained, this system will provide you with years of trouble-free service. The next sections contain important information on the proper care and maintenance of your system, please take a few minutes to read through this information.

The cartridges in this system must be replaced on a regular basis to maintain efficiency and to ensure high water quality. These cartridges work together and must be replaced every 6-12 months. Any significant change in performance of the system should be investigated promptly to avoid secondary damage or deterioration to other parts of the system.

Normally, the system cartridge is replaced during an annual filter change. However, if at any time you notice a reduction in water production or an unpleasant taste in the product water, it may be time to replace the 4-stage system cartridge and the in-line postfilter cartridge. Kinetico recommends replacing the 4-stage system cartridge when TDS reduction falls below 85%.

NOTE: Improperly installed systems could result in water damage due to leaks or flooding. Proper installation of this system requires familiarity with standard sink plumbing and proper use of common hand and power tools. This system has been designed for installation by licensed professionals, such as a contractor or plumber.

System Specifications

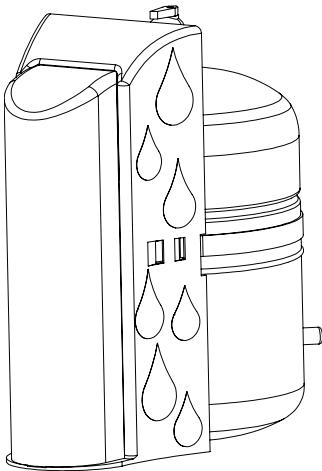

Dimensions and Weight

System

Dimensions	9.75" W x 13.5" D x 15.5" H (24.8 x 34.3 x 39.4 cm)
Weight	11 lbs. (5 kg.)

Shipping Box

Dimensions	14.5"L x 11.25"W x 20"H (36.8 x 28.6 x 50.8 cm)
Weight	13.7 lbs. (6.2 kg.)

Performance Specifications

Membrane Cartridge Production¹	50 GPD ¹
System²	
Production	14.61 GPD
TDS Rejection	96.5%
Recovery ³	26.76%

¹ Measured without tank

² System tested at 50 psig, 750ppm TDS at 77°F.

³ The percentage of the feed water available as reverse osmosis treated water under normal operating conditions.

Feed Water Requirements

Pressure	40-80 psi (275 kPa - 552 kPa)
Temp	40°F - 100°F (4°C - 38°C)
TDS	<2000 mg/L
Chlorine	<1.0 mg/L
Turbidity	<NTU
SDI	<5
pH	4-8

Feed water must be potable, municipal water. Must be free of potential membrane foulants such as Iron, Hydrogen Sulfide and Manganese. Do not use with water that is microbiologically unsafe or of unknown quality without adequate disinfection before or after the system.

Description of System and Replacement Intervals

Stage	Description	Replacement Interval	Part Number
1-4	4-Stage Cartridge 1. 20 micron sediment prefilter 2. Granular activated carbon prefilter 3. Reverse osmosis membrane 4. Granular activated carbon postfilter	12 months	17069
5	Granular activated carbon postfilter, located inline between tank and faucet	6 - 12 months	17070

Installation Overview

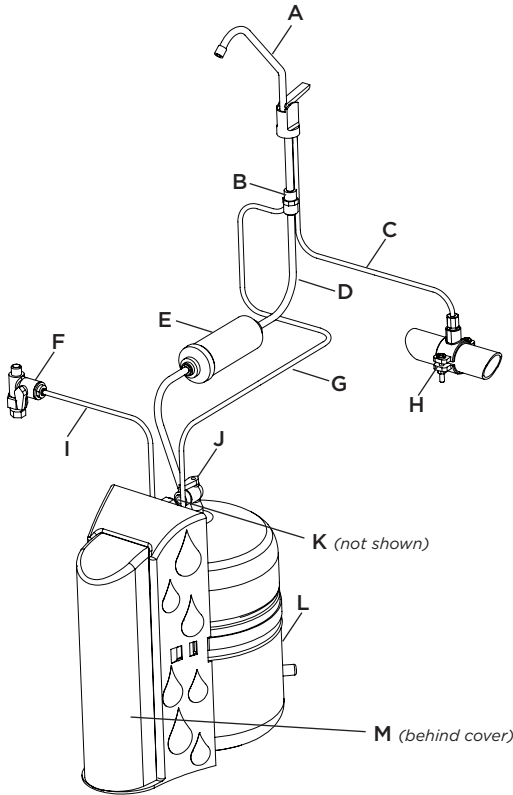

- A. Air-gap faucet
- B. Faucet quick connect fitting
- C. Drain tubing to drain saddle (white)
- D. Faucet tubing (blue)
- E. Postfilter
- F. Feed valve assembly
- G. Drain tubing to faucet (black)
- H. Drain saddle connection assembly
- I. Feed water tubing (green)
- J. Tank valve
- K. Tank tubing (white)
- L. Product water storage tank
- M. Four-stage membrane cartridge

Tools Required for Installation

- Drill with 3/8" (9.55mm) drill bit
- Screwdriver
- Adjustable wrench

Pre-Installation Checklist

1. System must be located where it will not be subject to physical impacts or rough contact by heavy objects.
2. System must be located next to a feed water plumbing and drain water plumbing. Typical installation locations include: under the kitchen sink, or in a basement location as close as possible to the faucet for best results.
3. The air-gap faucet installation will require a small hole to be drilled into the drain pipe under the sink.
4. The air-gap faucet requires a 1¼" (3.175mm) hole in the sink or counter top.

Installation - Push Handle Air-gap Faucet

Note: This faucet requires a 1 1/4" (3.175 cm) hole in the sink or counter top.

1. Locate the faucet parts bag and arrange the parts on the counter top in the sequence shown.
2. The last part in the sequence, the quick connect adapter (6), will be found in the smaller parts bag.
3. Locate the white piece of tubing, pull through the faucet hole in the sink. Pull the black and blue tubing up through the faucet hole in the sink.
4. Insert polished faucet base and rubber seal onto base of faucet.
5. Push the black drain tubing onto the smaller barb, located on the faucet base.
6. Push the white tubing onto the larger barb fitting, located on the faucet base.
7. Slide white plastic spacer, open-end-up, onto the threaded faucet stem (2).

Note: This spacer may be omitted if faucet is installed in a granite counter top (or counter top with similar thickness).

8. Loosely thread the washer (3), the serrated washer (4) and mounting lock nut (5) onto the threaded stem. Leave enough space for the slotted washer (1) which will be inserted in step 11.
9. Thread faucet quick-connect adapter (6) on to threads of faucet stem.
NOTE: This connection should be hand-tightened only. Push the end of blue tubing into this adapter.
10. Push the tubing assembly down into the faucet hole and position the faucet in the approximate final orientation.
11. From underneath the sink, slip the slotted washer (1) between the white plastic spacer and the sink. Check the orientation of the faucet on the sink. Securely tighten the mounting nut with a wrench.
12. If necessary, firmly insert spout assembly into the top hole of faucet body. You may swivel the faucet left or right.

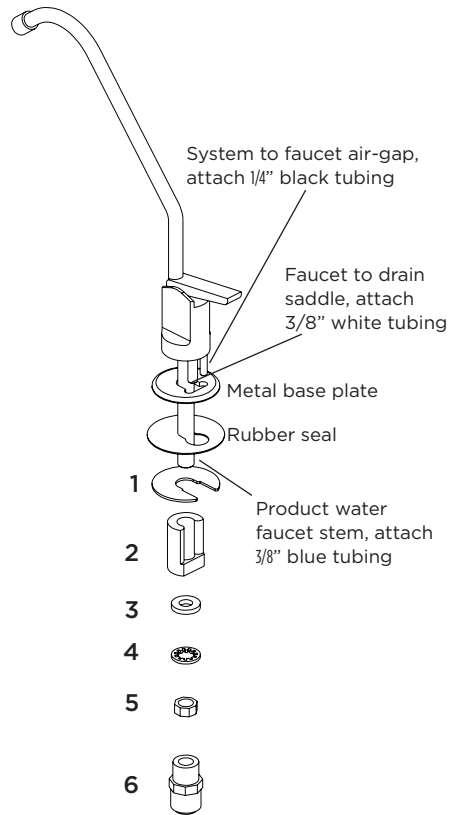

Installation - Feed Connection

Feed Connection

1. Locate and turn off the angle stop valve on the cold water line feeding the sink. This valve will usually be located under the sink on the pipe coming out of the wall.
2. When the angle stop valve is closed, relieve pressure in the line by momentarily opening the cold water tap on the sink.
3. Disconnect the cold water faucet feed line at the angle stop valve.
4. Install the feed valve assembly into the angle stop.
5. Firmly press the green tubing into the connector on the feed valve assembly.
6. Connect the cold water faucet feed line into the feed valve assembly.
7. Make sure the small shutoff valve on the feed valve assembly is closed.
8. Turn on the feed water connection valve.
9. Check for leaks.
10. Attach the small feed valve warning tag from the parts bag to the feed valve.
11. Attach the Shutoff Warning label to the system so that it is directly visible.
12. Fill out the Date of Installation label and attach to the side of the system.

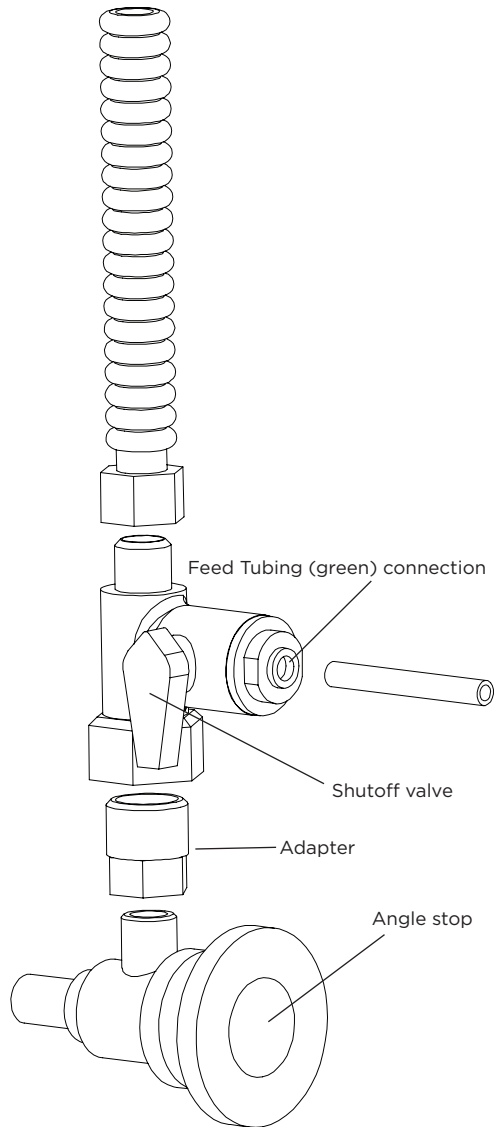

Installation - Drain Connection

Drain Connection

You will need an electric drill with a 3/8" (9.5mm) bit and a screwdriver for this portion of the installation.

Note: The drain saddle assembly must be installed before the 'P' trap. Do not install the drain saddle assembly between the 'P' trap and the wall.

1. Obtain the drain saddle assembly with two 1½" (38mm) bolts, two 3/8" (9.5mm) hex nuts, and the small adhesive foam pad from the small parts bag.
2. Place the adhesive foam pad on the inside of the drain saddle front, aligning the holes.
3. Position the drain saddle on the drain pipe under the sink between the "P" trap and the sink connection. Orient the drain saddle so that the opening is on the side of the drain pipe.
4. Using the bolts and hex nuts, hand tighten the saddle bracket evenly until the saddle grips the pipe snugly. Use a Phillips screwdriver to fully tighten the bolts. Do not over tighten.
5. If necessary, remove the drain saddle connector nut from the opening of the drain saddle. Using the connector opening in the side of the drain saddle as a guide, drill a 3/8" (9.5mm) hole through the side wall of the drain pipe. Do not drill the hole on the top of the pipe.
6. Extend the drain tubing from the dispensing faucet to the drain saddle and measure for length. The tubing must be routed so that water can run downhill for the entire length of the tubing from the faucet. Avoid low spots or loops. Cut the tubing shorter, if necessary.
7. Insert the black drain tubing from the dispensing faucet through the drain saddle connector nut. Tighten the connector nut onto the drain saddle.

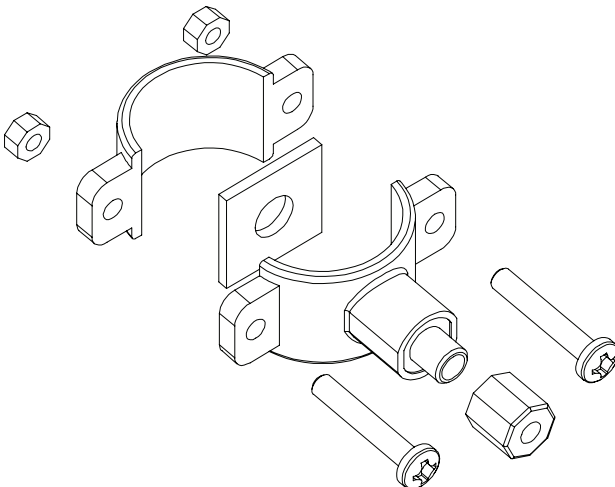

Installation - System Activation and Flushing

System Activation and Inspection

1. Check all tubing connections to ensure they are firmly seated. CHECK TO SEE THAT THE CARTRIDGE RETAINER CLIP IS PROPERLY ENGAGED AND LOCKED. Failure to keep the retaining clip in place will result in accidental leaks and flooding.
2. Open the dispensing faucet at the sink. Close the tank shutoff valve. Make sure the angle stop valve for the incoming water is open. Open the small feed shutoff valve on feed valve assembly.
3. Observe all tubing and connections for several minutes to detect any leaks. In approximately 5 minutes, (assuming normal feed water pressure) the dispensing faucet should begin dripping.
4. Allow the faucet to run for up to 15 minutes, then close the faucet.
5. Check for leaks at all connections.
6. Open the tank shutoff valve.

Initial Flushing Procedure

1. Before the system can be used for drinking water production it must be adequately flushed. Also, the carbon filter cartridge may release a small amount of carbon fines during the first tankful of flow. This flushing procedure will allow any carbon fines to pass from the system.
2. Initial tank filling will take approximately one hour (based on average feed pressure). When the tank is full, the water pressure will have risen to the point where the automatic shutoff valve inside the system will stop the feed flow through the system. Actuation of the automatic shutoff valve can be determined by either checking for a lack of brine flow to the drain saddle, or by listening very closely near the dispensing faucet for absence of water flow sound though the air gap.
3. After the tank is full, open the dispensing faucet fully and allow the product water to run out to drain at maximum flow. When the flow has diminished to a fast drip or small stream, close the dispensing faucet.
4. Fill and flush the tank twice prior to use. After this flushing procedure the system is ready for normal use.

Final Installation Checklist

1. Feed water pressure to the unit is no less than 40 psi and no greater than 80 PSI (275-552 kPa).
2. Ensure the plastic retainer clip that holds the desalinator cartridge in place is fully engaged and locked in place. The slide locks must snap into place in the slots. If the clip does not snap easily into place through the slots it means the cartridge is not fully inserted into the connectors. Press top or bottom of cartridge to engage connectors until it snaps into place properly.
3. All tubing connections, especially push-in quick connections, are fully inserted.
4. Tubing connected between the faucet and the drain saddle fitting (the fitting attached to the sink drain pipe) runs “downhill” to the drain. There should be no loops or places where water would not flow out to the drain.
5. Angle stop valve is open. The small shutoff valve on the feed valve assembly is open.
6. Within one to two hours after initial application of water pressure, check again for leaks especially at the tank, faucet tubing and connectors. These parts will not see full pressure until approximately 2 hours after the system is activated.

Maintenance

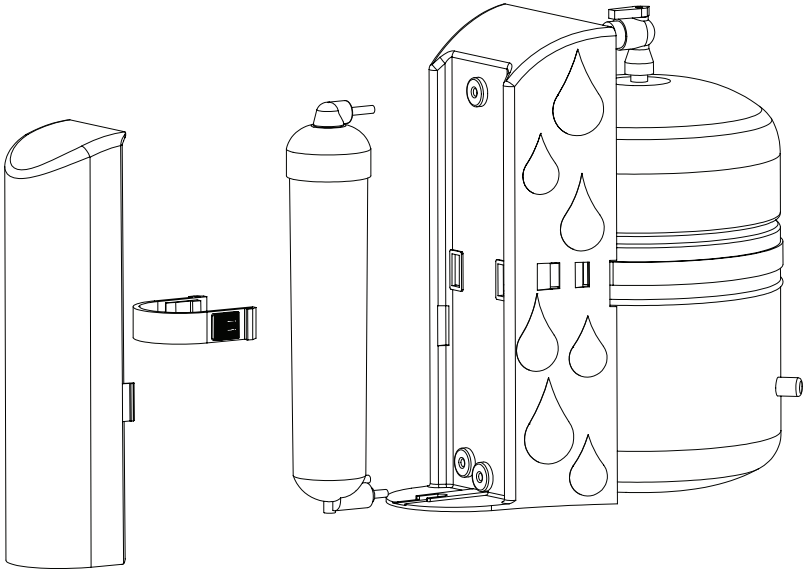

Maintenance - Main Cartridge Replacement

1. Close the small shutoff valve on the feed valve assembly.
2. Close the tank shutoff valve.
3. Open the dispensing faucet to relieve system pressure. Close dispensing faucet when flow has stopped.
4. Remove the cover from the front of the system. Remove the retaining clip. Pull the cartridge off the system evenly at top and bottom. Dispose of used cartridge.
5. Install the new cartridge, rocking gently from side to side as necessary until the cartridge tubes are properly engaged in the unit connectors. Install the retaining clip, ensuring the slide locks snap into place in the slots. If the clip does not snap easily into place through the slots it means the cartridge is not fully inserted into the connectors. Press the top or bottom of the cartridge to engage the connector so that it snaps fully into place. Failure to properly install the retaining clip will result in accidental leaks and flooding.
6. Open the small shutoff valve on the feed valve assembly. Open the dispensing faucet.
7. Close dispensing faucet after water starts running.
8. Observe system for any leaks, especially at newly replaced cartridge.
9. Open the tank shutoff valve.
10. The system should be flushed at least once as described in **System Activation and Flushing**.

Maintenance - Post Filter Replacement

Post Filter Replacement

1. Close the small shutoff valve on the feed valve assembly.
2. Close the tank shutoff valve.
3. Open the dispensing faucet.
4. Close the dispensing faucet when the water stops flowing.
5. Locate the in-line filter on the faucet line.
6. Remove the tubing by depressing the collet towards the filter and pulling the blue tubing from the filter.
7. Remove the other side of the blue tubing as described above.
8. Reverse the above steps to install the new in-line filter, making sure that the tubing is pressed in as far as possible.
9. Open the small shutoff valve on the feed valve assembly. Observe system for any leaks, especially at newly replaced cartridge.
10. Open the tank shutoff valve.
11. The system should be flushed at least once as described in System Activation and Flushing

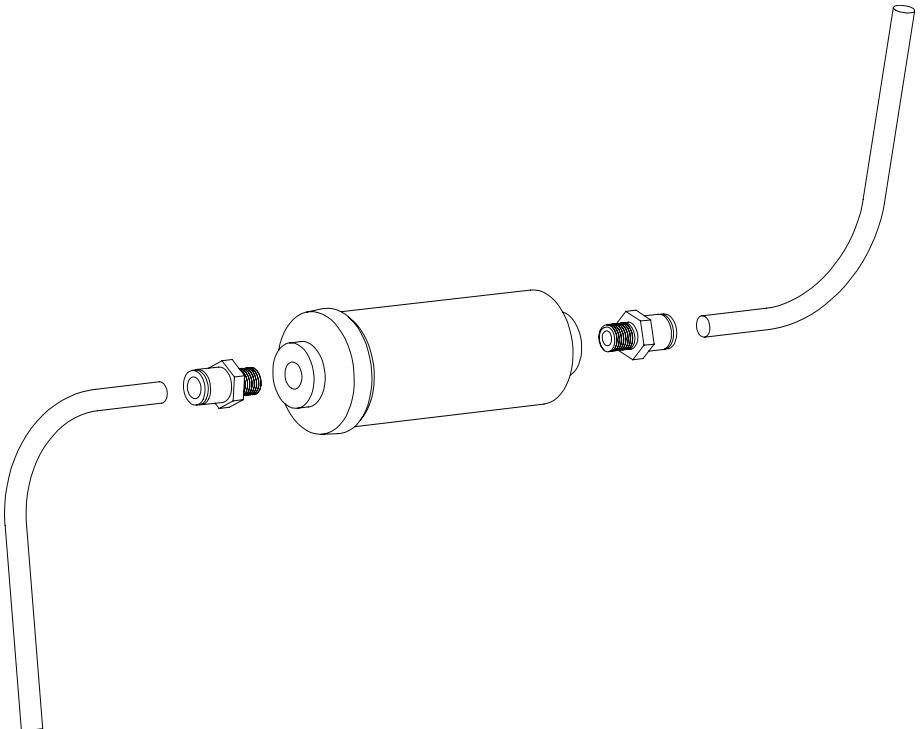

Maintenance - Tank Replacement

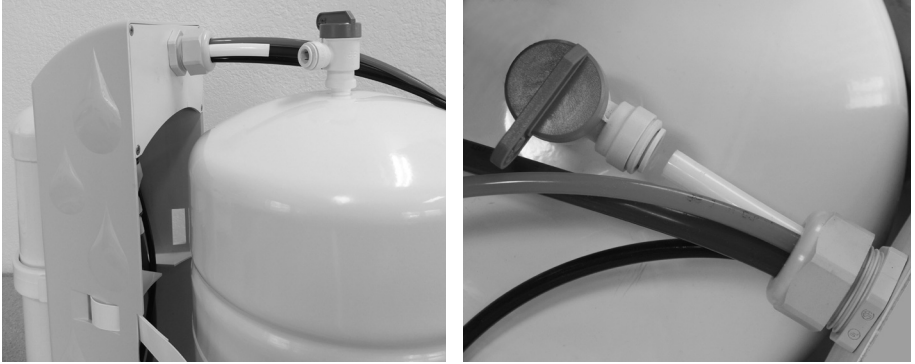

Note: Have a bucket and towel nearby to catch any water that may drip during this process.

1. Turn off incoming water at the feed valve.
2. Close the tank valve. The valve handle should be perpendicular to the white tubing.
3. Release the buckle on the white strap holding the tank to the frame. Loosen the strap around the tank.
4. Locate the collet on the tank valve quick connect fitting. Remove the red collet clip, if present. Press in the collet firmly while pulling the tank gently away from the white tubing.
5. Discard the old tank. Place new tank into position and firmly press together the tank valve quick connect fitting and the white tubing. (Do not allow the white tubing to slip into the frame during this procedure). The tubing will slide into the fitting easily until it hits the o-ring. Some force is required to push past this o-ring. When fully seated, the tubing will slide past the o-ring about 1/4" (6mm).
6. Relatch the strap around the tank, being careful not to twist the tank. Make sure the tank valve and white tubing are not pulled to one side during the strapping procedure.
7. Turn on tank valve.
8. Turn on feed valve. Check for leaks at the tank fitting. Re-seat if necessary.
9. The system should be flushed at least once as described in **System Activation and Flushing**.

1 Year Limited Warranty

This Limited Warranty extends to the original purchaser of the system only. This warranty covers all Manufacturer-supplied items only that prove to be defective in material, workmanship or factory preparation. This warranty covers parts only; all labor is excluded from this warranty, including, but not limited to, services related to the removal, replacement, installation, adjustment, maintenance and/or repair of the unit or its components items. excludes all non-Manufacturer labor required for any servicing of the unit, including, but not limited to, servicing related to installation, adjustment, maintenance and repair of the unit. This warranty applies only for the first full calendar year from date of purchase. The following items are excluded from this warranty: membranes, filters, O-rings, and all other parts or components that require regular replacement as a result of ordinary usage.

Disclaimers: This Limited Warranty applies only if the system is installed, used and maintained in compliance with all instructions and requirements enclosed with the system. This warranty will be void for failure to observe the following conditions:

1. The system is to be used with potable water from a municipal water system.
2. Feed water pressure to the unit is no less than 40 PSI and no greater than 80 PSI.
3. The system is to be used on water supplies with chlorine concentrations of 1.0 mg/L (ppm) or less.
4. Feed water temperature to the unit must be no less than 40°F and no more than 100°F.
5. Total dissolved solids in feed water must be less than 2,000 mg/L (ppm).
6. Feed water must have a pH between 4 and 8.
7. Turbidity must be less than 1.0 NTU.
8. SDI must be less than 5.
9. Feed water must be completely free of iron, manganese or hydrogen sulfide.

Do not use with water that is microbiologically unsafe or of unknown quality without adequate disinfection before or after the system.

The Manufacturer does not know the characteristics of your water supply. The quality of water supplies may vary seasonably or over a period of time. Your water usage may vary as well. Water characteristics can also change if the drinking water appliance is moved to a new location. The Manufacturer assumes no liability for the determination of the proper equipment necessary to meet your requirements, and we do not authorize others to assume such obligation on our behalf.

This Limited Warranty does not cover any Manufacturer-supplied items that are defective as a result of the use of improper parts, equipment or materials. This warranty does not cover alterations or modifications of the unit, or failure of a unit caused by such alterations and modifications.

This Limited Warranty does not cover malfunctions of the unit due to tampering, misuse, alteration, lack of regular maintenance, misapplication, fouling due to hydrogen sulfide, manganese or iron, scaling from excessive hardness, turbidity greater than 1.0 NTU, Silt Density Index (SDI) greater than 5.0 SDI, or excessive membrane hydrolysis due to chlorine levels in excess of 1.0 mg/L (ppm). In addition, damage to the unit due to fire, accident, negligence, act of God, or events beyond the control of the Manufacturer are not covered by this warranty.

Incidental and Consequential Damages Limitation: The Manufacturer will not be responsible for any incidental or consequential damages as a result of the failure of this unit to comply with express or implied warranties or any defect in the unit, including but not limited to, lost time, inconvenience, damage to personal property, loss of revenue, commercial losses, postage, travel, telephone expenditures, or other losses of this nature. Some states do not allow the exclusion or limitation of incidental or consequential damages, so this exclusion may not apply to you.

Owner's Warranty Responsibilities: As a condition of this Limited Warranty, the owner must ensure periodic maintenance of the system is performed as described in the literature enclosed with the system. Neglect, improper maintenance, abuse, modification or alteration of the unit will invalidate this Warranty. Should your unit develop a defect or otherwise fail to perform in accordance with this warranty, you should contact the retailer from whom the product was originally purchased.

Implied Warranties: The implied at-law warranties of merchantability and fitness for a particular purpose shall terminate on the date one year after the date of purchase. Note: some states do not allow limitations on how long an implied warranty lasts, so the above limitations may not apply to you.

Other Rights: This Warranty gives you specific legal rights and you may also have other rights which vary from state to state.



© 2018 **Kinetico Incorporated**

Corporate Headquarters
10845 Kinsman Road
Newbury, Ohio 44065

www.kinetico.com

Part No. 17066
08/2018